

Walker Farm Estates



New Castle County Council
Land Use Committee

Walker Farm Estates



* South side of Old Lancaster Pike, east of Kings Grant Road

Walker Farm Estates



- Rezoning from NC21 to ST
 - Positive recommendation from the Department and Planning Board
 - County Council approved the rezoning/site plan in April, 2013
- Proposes 6 additional single family detached lots and 39 single family attached lots
- County Council approved a subdivision variance to allow a cul-de-sac to serve 39 lots

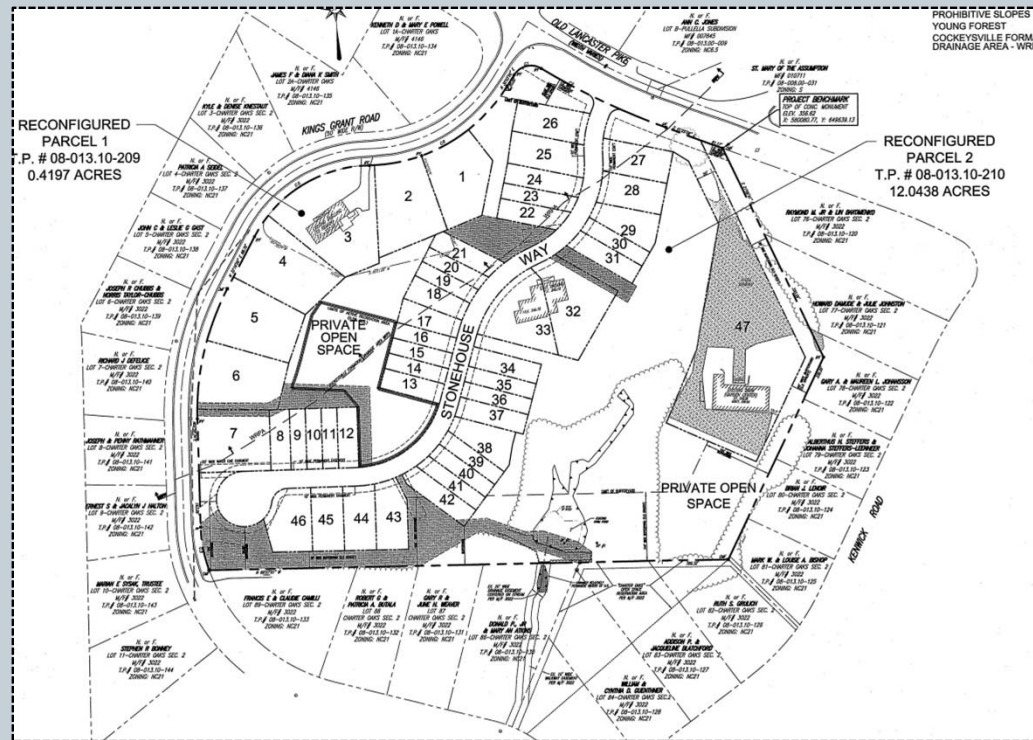

Walker Farm Estates



- **Issues**

- Plan approved by the Historic Review Board – preservation of the stone farmhouse
- Several variances were approved by the Board of Adjustment
 - ✦ Paving setbacks and landscaping associated with the existing non-conforming barn/garden center
 - ✦ Dwelling unit mix requirement
- Pedestrian connection from proposed Stonehouse Way to Kings Grant Road
- State investment level 2
- TIS not required

Walker Farm Estates



Council Consideration